

1 Parts description

Visit operation detail at Super B

Website: <http://www.superbiketool.com/>

Click Product ➔ Bottom & Crank tool ➔ 7. ➔ TB-19003

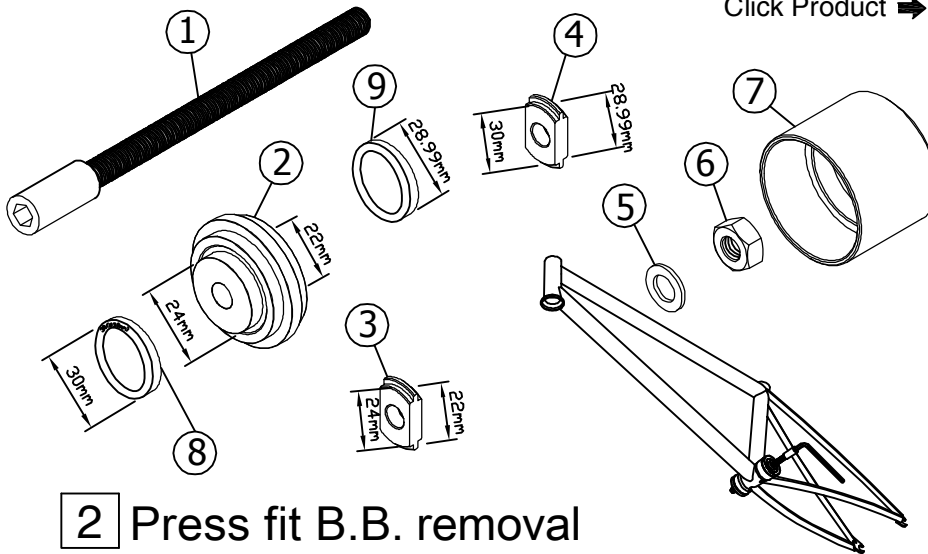

NO.	PART	Q'TY
①	Threaded rod	1
②	Bushing	2
③	22mm+24mm plate	1
④	28.99mm+30mm plate	1
⑤	Washer	1
⑥	M10 nut	2
⑦	Cover	1
⑧	30mm adaptor	2
⑨	28.99mm adaptor	2

⚠ Please prepare : 8mm hex wrench,
17mm open-ended wrench

2 Press fit B.B. removal

A. To remove press fit B.B. bearing. For example, 24mm press fit B.B bearing:

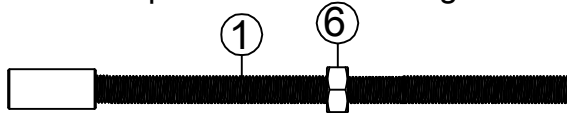

(Picture 1)

1. Screw the M10 nut ⑥ to threaded rod ① at proper position. (see picture 1)

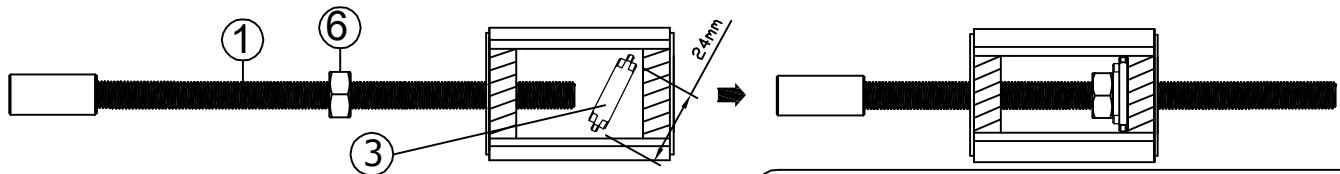

∅24mm press fit B.B.
(Picture 2)

There are 2 sizes on each plate. For instance, to remove 24mm press fit bearings, put 24mm side ③ toward B.B. bearings.

2. Put the 22mm+24mm plate ③ obliquely into the bottom bracket and assemble on the threaded rod ①. Put the 22mm+24mm plate ③ and M10 nut ⑥ against the inner side of the bottom bracket. (see picture 2)

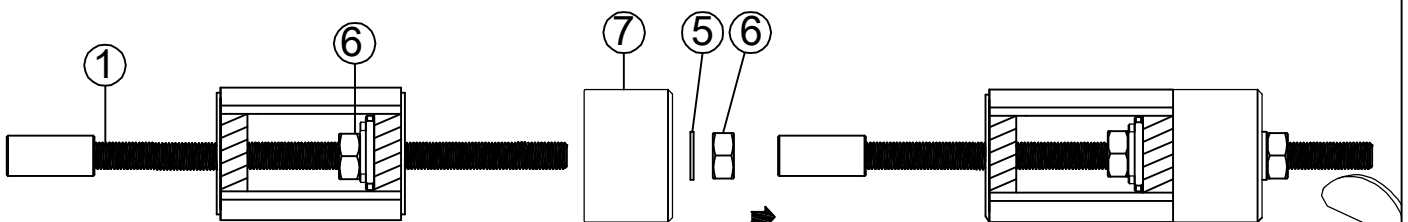

(Picture 3)

3. Place the cover ⑦, washer ⑤ and M10 nut ⑥ into the threaded rod ① in order, then tighten the M10 nut ⑥ with a 17mm open-ended wrench. (see picture 3)

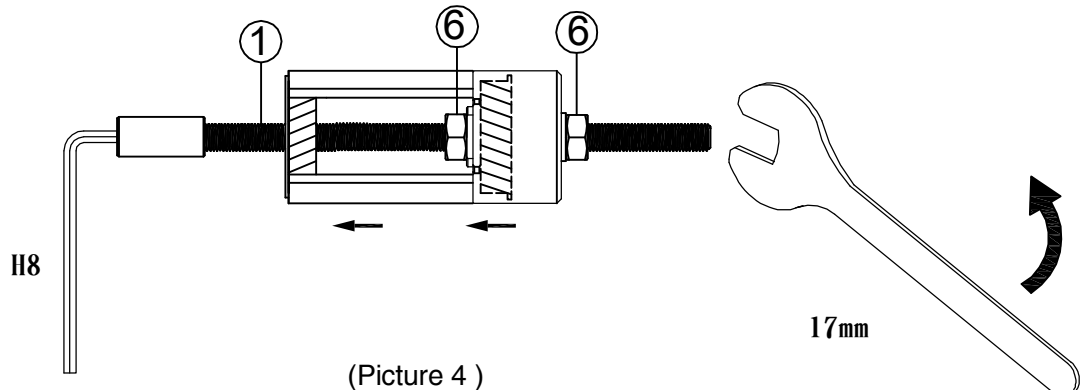

(Picture 4)

4. Fix the threaded rod ① with a 8mm hex wrench, then turn the M10 nut ⑥ with a 17mm open-ended wrench until the bottom bracket bearing is pulled out completely. (see picture 4)

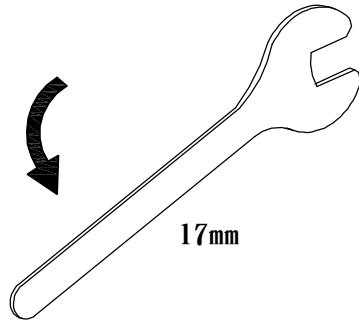

17mm

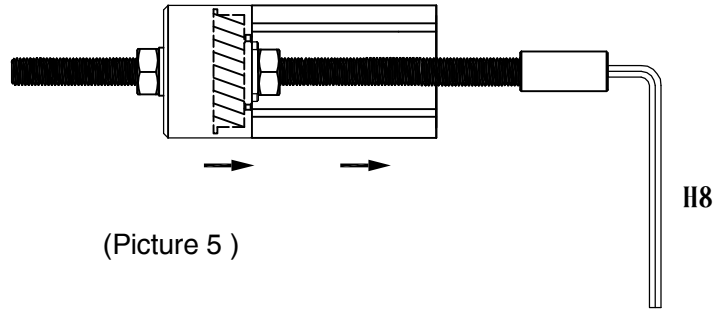

(Picture 5)

5. Take off the removed B.B. bearing from the cover ⑦ and repeat steps 1~4 to remove the other B.B. bearing. (see picture 5)

B. To remove 28.99mm, 30mm press fit B.B. bearing:

1. Change 28.99mm+30mm plate ④ and repeat above steps 1 to 5.

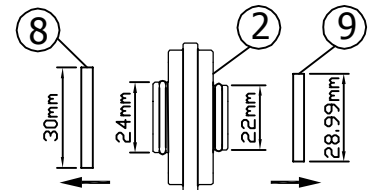

(Picture 6)

3 Press fit B.B. installation

A.a. Remove and assemble 28.99mm adaptor ⑨ and 30mm adaptor ⑧ from bushing ② (see picture 6) according to the different sizes of B.B. bearing.

b. To assemble B.B. bearing. For example, 24mm B.B. bearing:

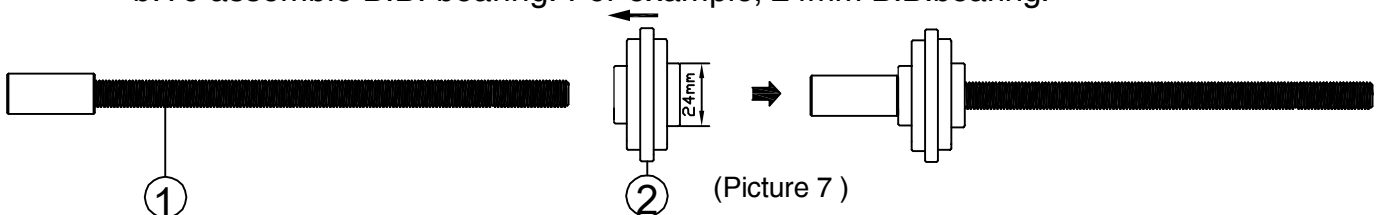

(Picture 7)

1. Remove 30mm adaptor ⑧ from bushing ②, put bushing ② through threaded rod ①. (see picture 7)

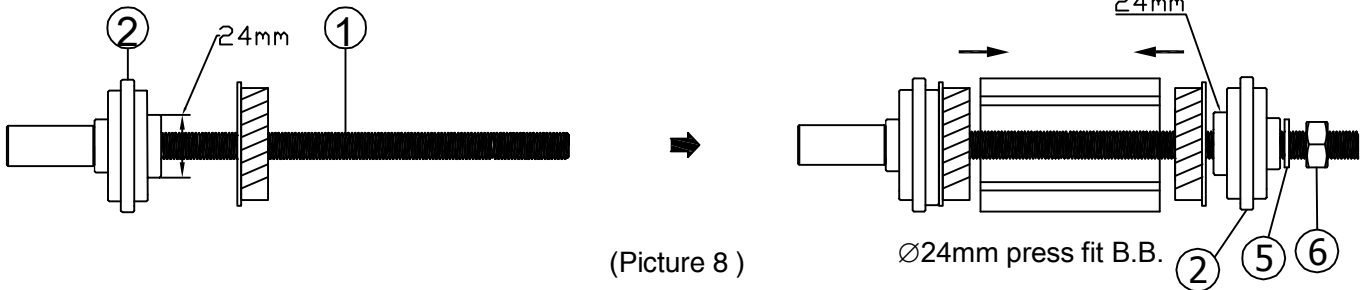

(Picture 8)

2. Put one B.B. bearing on threaded rod ①, make threaded rod ① to go through the B.B., then put the other B.B. bearing, bushing ②, washer ⑤ and M10 nut ⑥ to threaded rod ① in order. (see picture 8)

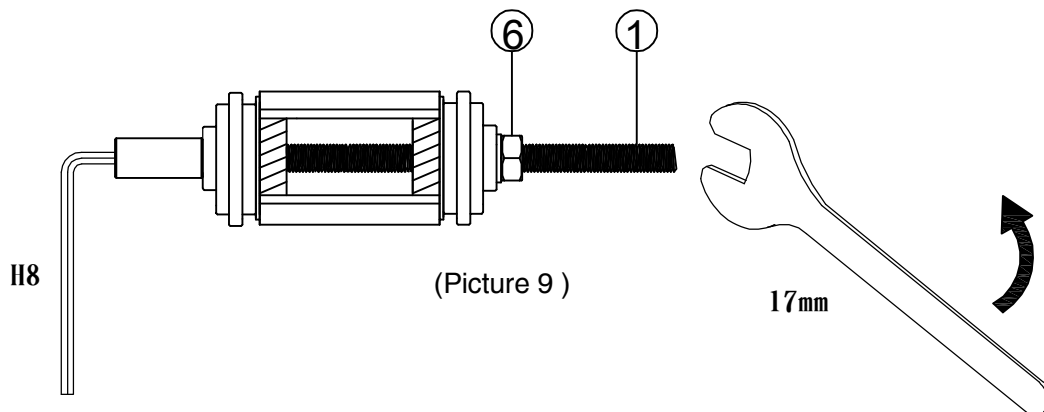

(Picture 9)

3. Fix threaded rod ① by a 8mm hex wrench, then tighten M10 nut ⑥ by 17mm open-ended wrench until both sides of B.B. bearings completely fit in the B.B. (see picture 9)

B. To assemble 30mm B.B. bearing:

1. Assemble 30mm adaptor ⑧ on the 24mm side of bushing ②, 30mm side faces toward to B.B. shell and repeat above steps 1-3.