

Micrometer Adjustable Torque Wrench

2-24 NM

Operating Instructions :

1. Balancing wrench in hand with graduations visible with the marked arrow scale up.
2. Unlock knurled handle by turning lock nut counter clockwise.
3. Set amount of torque in Newton-Meter (=NM). The red needle shows exact amount.
4. Turning knurled handle to read exact amount on the case graduations.
5. Lock handle securely by turning lock nut clockwise, and now the wrench is set at exact amount which is ready to use.
6. Install the proper socket or attachment to the square drive and pull handle until you feel and/or hear wrench click.
7. Remove the socket by pressing the button on the top.
8. Reset the amount of torque for next operation.

Do not continue to pull after wrench releases. Use special care at low torque settings that will pull stops when wrench clicks.

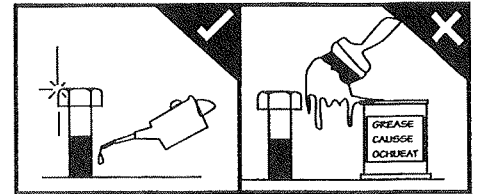
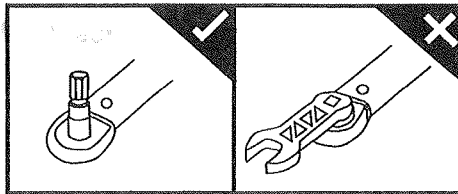
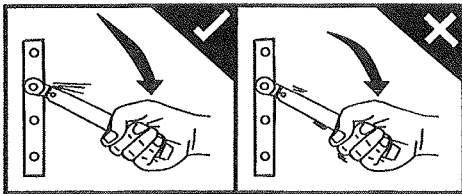

Caution:

1. If wrench has not been used or has been in storage for some time, operate it several times at a low torque setting which permits special internal lubricant to re-coat internal working parts.
2. Do not set the amount of torque below 2NM or over 24 NM.
3. Do not continue pulling on the wrench after pre-set torque has been reached and the wrench has been released.
4. Clean wrench by wiping. Do not immerse in any type of cleaner which may affect special high pressure tube with which the wrench is packed at the factory.
5. The torque wrench was calibrated and tested before leaving the factory and is accurate to $\pm 4\%$.
6. This is a precision measuring instrument and should be treated with care. Calibration and servicing must be done regularly and is the owner's responsibility.

